

Installation manual combination surface-mounting socket outlet

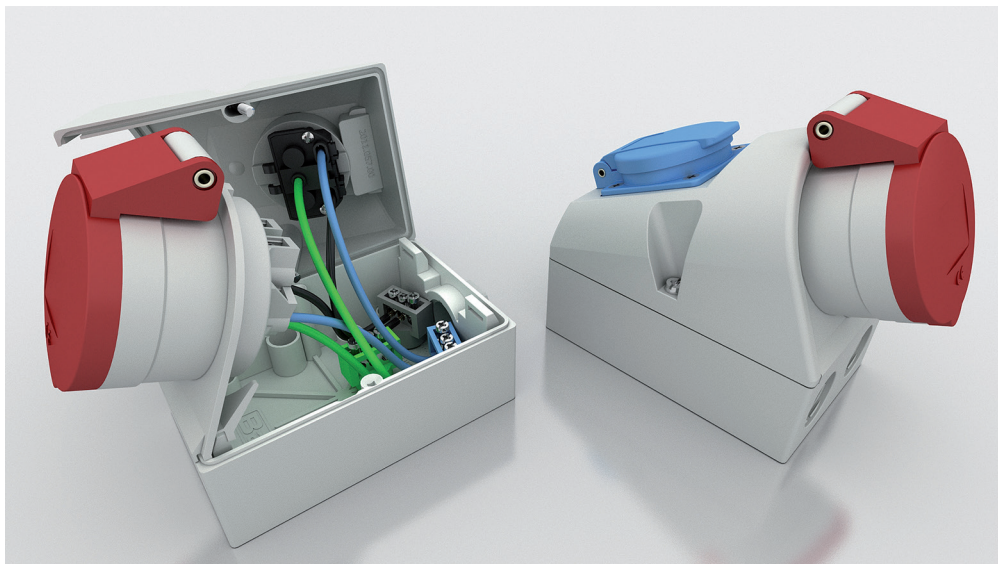

Table of contents

1	About this manual	3
1.1	Structure of the warnings	3
1.2	Symbols used	4
1.3	Signal words used	4
2	Intended use	5
3	General safety instructions	6
4	Packaging, transport and storage	7
4.1	Packaging	7
4.2	Transport	7
4.3	Storage	7
5	Design	8
6	Assembly and disassembly	9
6.1	Connecting a cable to a combination surface-mounting socket outlet	9
6.2	Disconnecting a cable from a combination surface-mounting socket outlet	13
7	Cleaning and care	15
8	Decommissioning and disposal	15

1 About this manual

This manual

- describes the assembly and disassembly of combination wall socket outlets from Bals Elektrotechnik GmbH & Co. KG
- is an integral part of the product and must be kept in safe custody during the product service life
- must be read carefully and understood before use and any work.

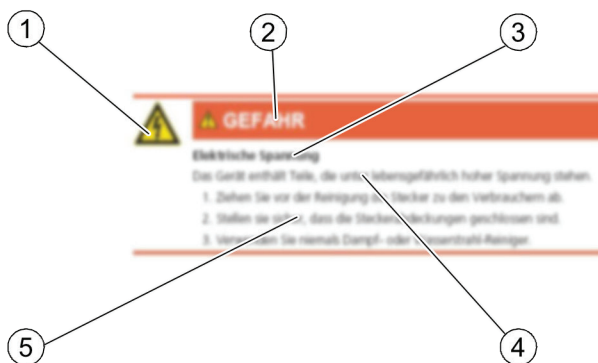

1.1 Structure of the warnings

The following picture illustrates the structure of a sample warning.



1	Hazard-specific symbol
2	Signal word
3	Type and source of the hazard
4	Possible consequences of failing to comply
5	Procedure for avoiding hazards

1.2 Symbols used

	General warning of a hazardous area
	Warning – dangerously high voltage
	Notice

1.3 Signal words used

All warnings in this manual are clearly highlighted. The following signal words are used for warnings:

DANGER	Warns of dangers which will lead to serious injuries or to death if the instructions are not followed.
WARNING	Warns of dangers that may lead to serious injuries or to death and/or cause considerable damage to property if the instructions are not followed.
CAUTION	Warns of dangers that may lead to reversible injuries and/or considerable damage to property if the instructions are not followed.
NOTICE	Warns of dangers that may lead to operational disruptions and/or considerable damage to property. Damage to the environment, too, may occur if the instructions are not followed.

2 Intended use

Socket outlets are built for professional use. The installation and the fixed connection to the mains supply should be carried out only by trained and qualified experts.

Any use going beyond the intended use is considered to be improper. The manufacturer is not liable for damages resulting from improper use. Any such risk shall be borne solely by the user.

In case of unauthorised modifications or conversions, the CE conformity becomes null and void, and thus, also all claims for warranty. Modifications may lead to risks for life and limb as well as damage to the plugs and sockets or loads connected.

Factory-fitted labels and markings on the plugs and sockets should not be removed, modified or blurred.

The product complies with protection degree IP44 according to **DIN EN 60529** (VDE 0470-1). In this context this means:

- Protection degree IP44:
 - Protected against solid bodies with a diameter beyond 1.0 mm, e.g. a wire
 - Protection against water sprayed from all sides

Environment

The following operating conditions apply for the safe operation of the product:

Size	Value
Temperature	-25 °C ... +40 °C
Humidity	10 %rH ... 90 %rH

3 General safety instructions



- Safe use is ensured only if this manual is followed completely.
- Before installation, commissioning or operation, read this manual thoroughly.
- The product must be installed, maintained and put into operation properly by qualified experts in accordance with the laws, ordinances and standards.
- Keep easily combustible and explosive materials away from the product.
- Handle the cables with care,
 - by always pulling at the plug and not the cable when unplugging,
 - by preventing the cable from getting damaged mechanically,
 - by keeping intense heat away.
- Never use faulty products or products with dirty, scratched or damage contacts.
- Keep the contacts on the product clean.
- Avoid tripping hazards.

4 Packaging, transport and storage

4.1 Packaging



Packaging materials are valuable raw materials and can be reused. The packaging materials should therefore be brought to an appropriate recycling facility. If this is not possible, dispose of the packaging materials according to the locally applicable regulations.

4.2 Transport

Check the delivery for completeness and integrity. If you identify transit damage or if the delivery is incomplete, notify your dealer or supplier immediately.

4.3 Storage

The product must be stored in clean condition and protected from dust and humidity. The original packaging is best suited for this purpose.

5 Design

Based on an example, the following figure illustrates the main components of a combination surface-mounting socket outlet.

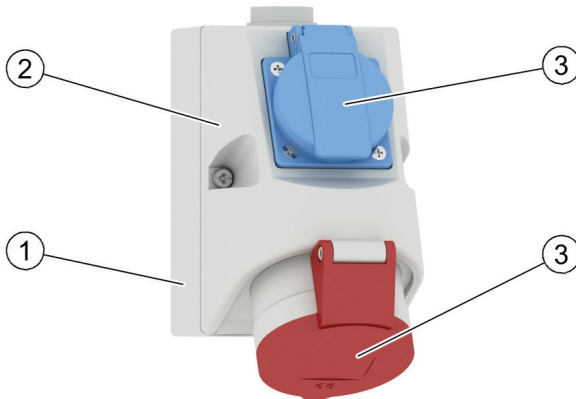

1	Bottom part of housing
2	Top part of housing
3	Folding cover

Conductor cross-sections

The following table displays the possible conductor cross-sections that can be connected to 16A/32A variants:

Design	Possible conductor cross-section
16A	1.5 mm ² ... 4 mm ²
32A	2.5 mm ² ... 10 mm ²

Technical specifications

The technical specifications of the product depend on the design. You will find them in our catalogue or on our website <http://www.bals.com>.

6 Assembly and disassembly



DANGER

Danger to life by electrical voltage

The supply cable may carry high electrical voltage that is fatal. Pay attention to the five safety rules of electricity:

1. De-energise
2. Secure the supply from being switched on again
3. Ensure the de-energised condition
4. Connect to earth and short circuit
5. Cover or cordon off adjacent live parts

6.1 Connecting a cable to a combination surface-mounting socket outlet

Proceed as follows:

1. Make sure that the cable is de-energised.
2. Strip the cable to the required length.
3. Remove the insulation from the individual conductors (16 A designs: 9 mm; 32 A designs: 12 mm). Twist the multi-strand copper conductors slightly by hand for flexible conductors. For better, permanent contact, provide the individual conductors with suitable conductor end sleeves.
4. Loosen the two housing screws in order to open the housing.

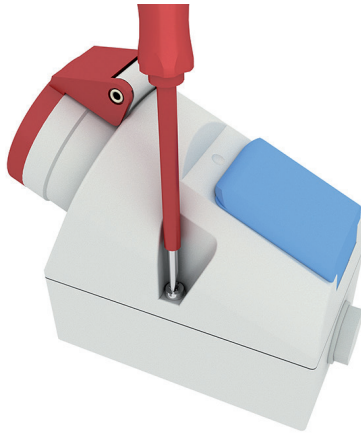

5. For variants without wiring: Create the necessary connections within the surface-mounting socket outlet according to one of the three possible connection options and test them. Tighten the screws on the connection terminals (7) with a torque of at least 1.2 Nm.

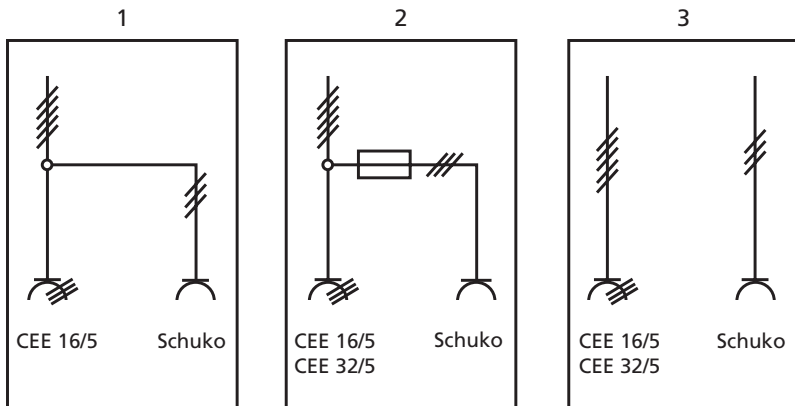

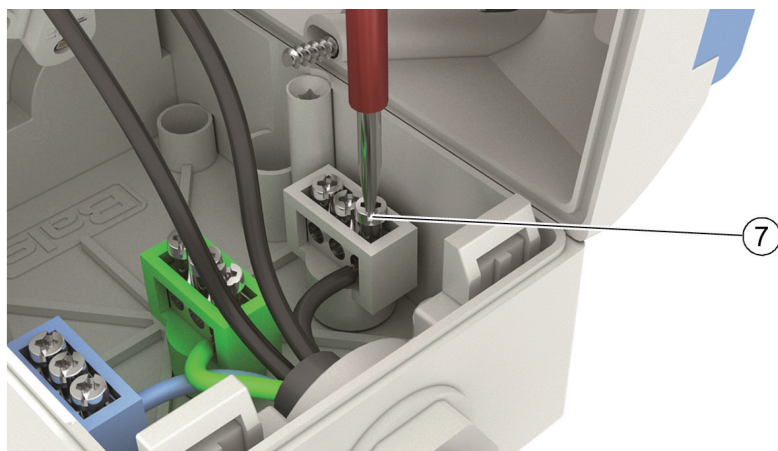

6. Fix the bottom part of the housing to the wall with the help of the fixing material suitable for the application. Break out the four mounting holes on the base of the housing.
7. Push the cable through one of the cable glands (4) into the housing.

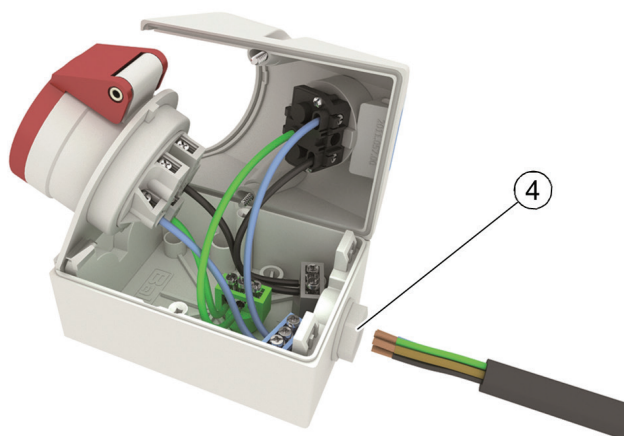

8. The terminals are open at the time of delivery. Guide the bare individual conductors into the opening (6) and tighten the screw (5) with a torque of at least 0.8 Nm. Take care to ensure that only the bare individual conductor (without insulation) is clamped. Pay attention to the

marking of the terminals and ensure that the assignment of the individual conductors to the terminals is correct. Phase L1 is connected to the terminal on the base of the housing, phases L2 and L3 are connected directly to the terminals of the three-phase outlet.

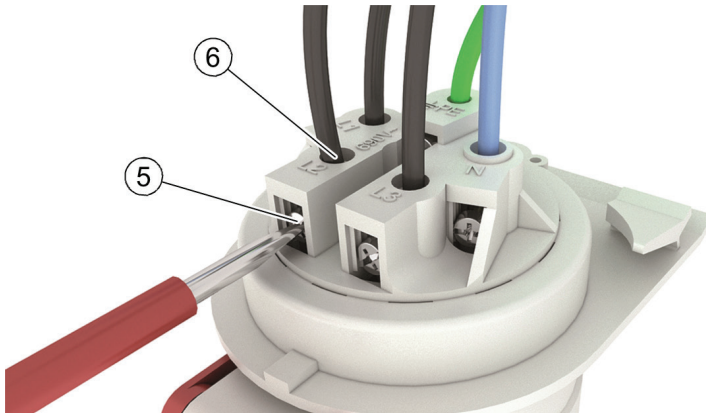

9. Check whether the individual conductors are seated tightly by pulling them lightly. If this is not the case, open the terminal and repeat the previous step.
10. Tighten the cable gland.
11. Screw the top part of the housing to the bottom part of the housing. NOTICE! Ensure that you locate the insert with the connections correctly in the bottom part of the housing!

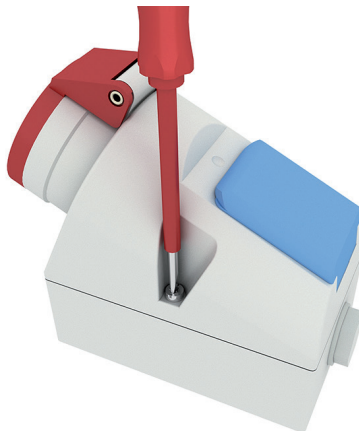

6.2 Disconnecting a cable from a combination surface-mounting socket outlet

1. Make sure that the cable is de-energised.
2. Loosen the two housing screws in order to open the housing.

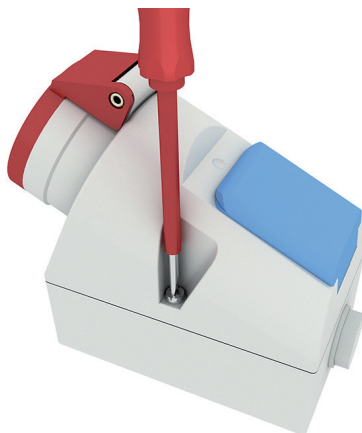

3. Loosen the screws on the contacts of the connection terminal and the screws (5) on the contacts of the three-phase outlet to which the cable is connected, and pull the individual conductors out of the terminals.

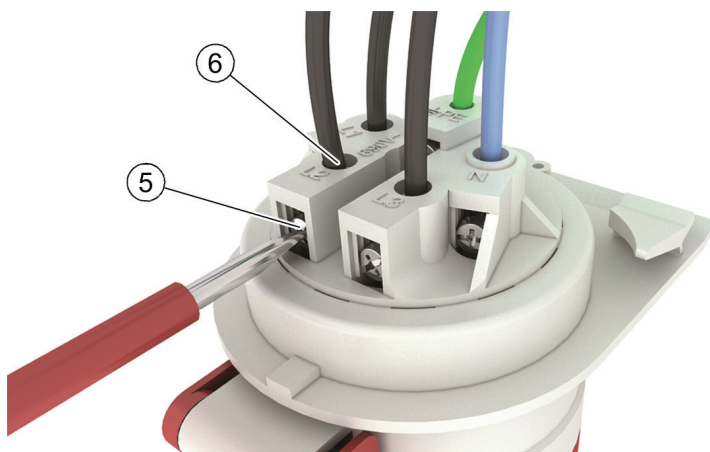

4. Pull out the cable out of the cable gland (4).

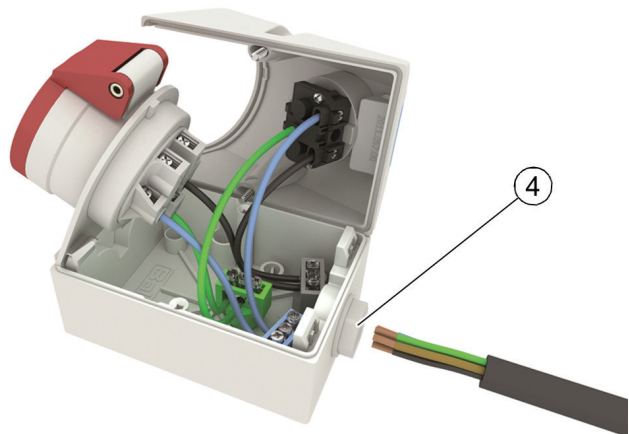

5. Screw the top part of the housing to the bottom part of the housing.

7 Cleaning and care

It is recommended to clean the device as required. Use a dry cloth to clean the device. Use a wet cloth if the device is very dirty.



DANGER

Electrical voltage

The device contains parts that carry hazardous voltage that may be fatal.

1. Pull out the plugs to the loads before cleaning them.
2. Make sure that the plug covers are closed.
3. Never use steam or water jet cleaners.



NOTICE

Damage to the plastic parts.

Corrosive cleaning agents may attack or destroy the plastic parts.

Use only a cloth moistened with water for cleaning.

8 Decommissioning and disposal



Send the worn-out product for recycling or for proper disposal. Always make sure to observe and follow the local regulations.

The product should not be disposed of in household waste. Environmental damage and risk to personal health are avoided with proper disposal.

Bals Elektrotechnik GmbH & Co. KG

Burgweg 22

57399 Kirchhundem

GERMANY

Tel.: +49 27 23 / 7 71-0

Fax: +49 27 23 / 7 71-1 77

E-mail: info@bals.com

Disclosure to third parties only with the consent of

Bals Elektrotechnik GmbH & Co. KG.

All rights reserved. Only valid at the time of printing. Update when reused.